

GENERAL INFORMATION

CUSTOMER: _____ REQUESTED BY: _____ DATE: _____

APPLICATION DESCRIPTION: _____

CLEAR FORM

GWR II-

MOUNTING OPTIONS

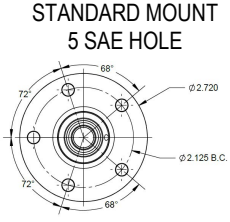

STANDARD MOUNT
5 SAE HOLE

THREAD ADAPTER
1" NPT

1-1/4" 2"

1-1/2" 2-1/2"

MECHANICAL SPECIFICATIONS

OPERATING PRESSURE

CONTINUOUS: 6 psi
 MAXIMUM: 15 psi

OPERATING TEMPERATURE

MINIMUM: -40C
 MAXIMUM: 85C

OPERATING RESOLUTION

RESOLUTION: 2mm
 ACCURACY: ± 3%

TANK DATA

WORKING MEDIA: HYDROCARBONS
 AQUEOUS SOLUTIONS
 OTHER _____

GUIDED WAVE RADAR II

IMAGES ARE NOT TO SCALE AND FOR REFERENCE ONLY

LENGTH REQUIREMENTS

UNITS: _____

OVERALL LENGTH (OAL) : _____
MINIMUM OAL IS SET TO 7.875"

DESIRED FULL FROM MOUNTING SURFACE: _____
MINIMUM UPPER DEADBAND IS 1" FROM MOUNTING SURFACE
 LOWER DEADBAND IS 0.5" FROM BOTTOM OF PROBE

HARNESS & CONNECTORS

STANDARD OPTION:
24" HARNESS FLYING LEADS

CUSTOM HARNESS:
 DESIRED HARNESS LENGTH: _____
 DESIRED CONNECTOR: BRAND: _____
 MODEL #: _____

ELECTRONIC OUTPUT

VOLTAGE	CURRENT
0V - 5V 0.5V - 4.5V	4-20 mA

DESIGN BASED ON 3-WIRE; SUPPLY VOLTAGE 9V TO 32V

GENERAL

APPROVAL SAMPLES REQUIRED: YES NO
 QUANTITY: _____ DELIVERY TIME: _____
 ESTIMATED ANNUAL USAGE: _____

COMMENTS